

Front view and mounting

Side view

Rear view

Y view

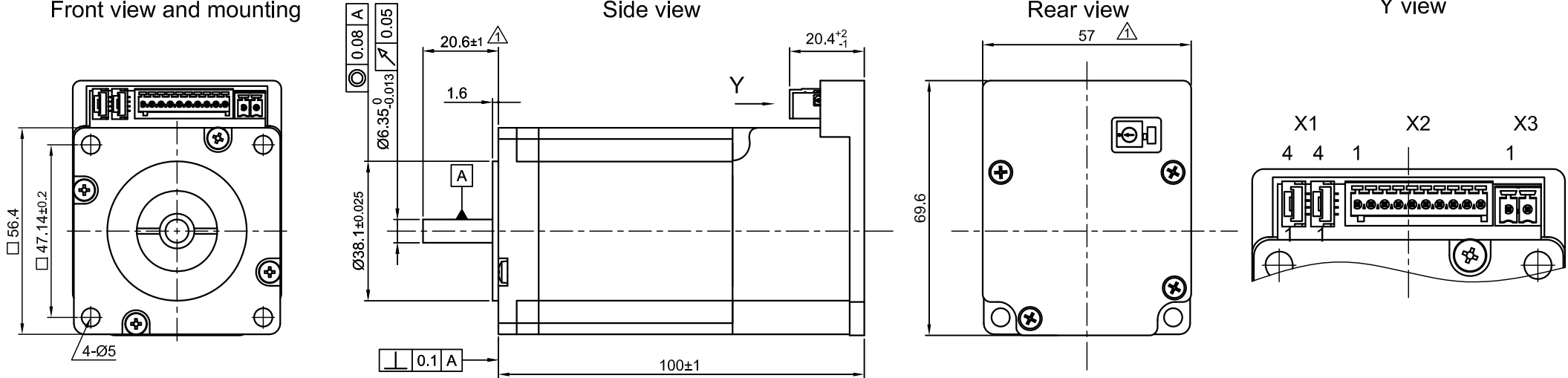

CONNECTION	BIPOLAR	PERMISSIBLE RADIAL+AXIAL FORCE
SPECIFICATION		
VOLTAGE (VDC)	12 TO 48	<p>ROTOR SPRING-MOUNTED IN AXIAL DIRECTION</p> <p>SPRING WASHER</p> <p>BEARING</p> <p><math>F_r</math></p> <p><math>F_a</math></p> <p><math>a</math></p>
AMPS/PHASE(A)	4.2	
HOLDING TORQUE (Nm) [lb-in]	1.87 [16.55]	
DETENT TORQUE (Nm) [lb-in]	0.068 [0.602]	
STEP ANGLE (°)±ACCURACY	1.8±5% TO MICROSTEP	
WEIGHT (Kg) [lb]	1.1[2.43]	
OVERTEMPERATURE PROTECTION (ELECTRONICS): 75°C		AXIAL-FORCE $F_a$ (N)
AMBIENT TEMPERATURE -10°~ 50°C [14°F ~ 122°F] (HIGHER TEMPERATURE REDUCES DUTY CYCLE)		DISTANCE $a$ (mm)
INSULATION RESISTANCE 100 MØhm (UNDER NORMAL TEMPERATURE AND HUMIDITY)		RADIAL-FORCE $F_r$ (N)
INSULATION CLASS B 130° [266°F]		AXIAL
DIELECTRIC STRENGTH 500VAC FOR 1 MIN. (BETWEEN THE MOTOR COILS AND THE MOTOR CASE)		SHAFT PLAY (mm)
AMBIENT HUMIDITY MAX. 85% (NO CONDENSATION)		AT LOAD MAX: (N)
		AXIAL
		RADIAL

X1, JST GH-4	
PIN No.	Function
1	+UB_LOGIC(24V)
2	CAN+
3	CAN-
4	GND

X2, Phoenix MCV-10	
PIN No.	Function
1	GND
2	Analog input (0-10V)
3	+12V (Voltage Output, max.100mA)
4	Output1 (open drain)
5	Output2 (open drain)
6	Input1 (+5/+24V)
7	Input2 (+5/+24V)
8	Input3 (+5/+24V)
9	Input4 (+5/+24V)
10	GND

X3, Phoenix FMC-02	
PIN No.	Function
1	+VCC(12-48V)
2	GND

2	NEW HOLDING TORQUE	11.10.16	GYQ	<p><b>Nanotec</b><sup>®</sup> PLUG &amp; DRIVE</p>	APVD	G.M.	16.05.14	<p><b>PLUG&amp;DRIVE MOTOR</b></p>			
1	REWORK DRAW/CHANGE TOLERANCE	04.07.16	GYQ		CHKD						
REV	DESCRIPTION	DATE	DRN	Surface specification DIN ISO 1302	General tolerances DIN ISO 2768-cH	Work piece edge DIN ISO 13715	DRN	GYQ	16.05.14	DWG.NO	PD4-C5918L4204-E-08
							SIGNATURE		DATE		